

**SAVE TIME AND MONEY!**

Learn about all our products and watch installation videos at:

[www.sinkits.com](http://www.sinkits.com)

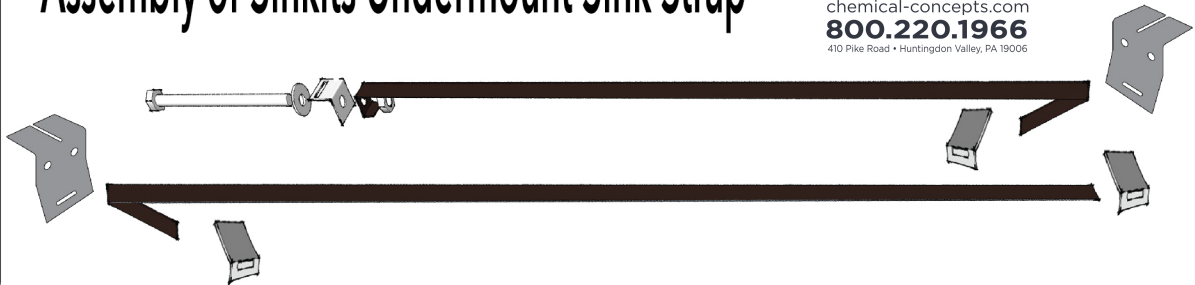

## Sinkits Undermount Sink Strap Installation Instructions

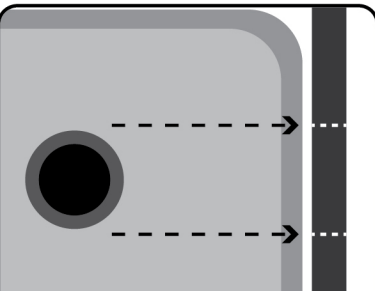

**1** Locate and mark the bracket locations so the strap will be just in front or behind the sink drain.

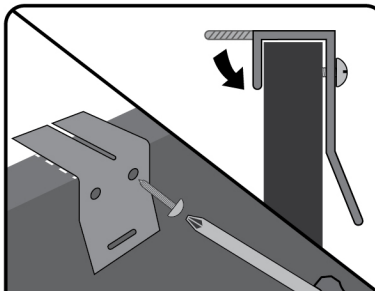

**2** Install the mounting brackets with the provided screws. Bend the mounting tabs down over the cabinet divider for added strength.

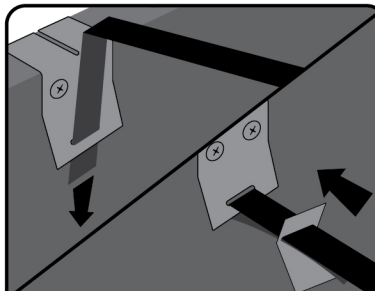

**3** Insert the prebent strap ends into the mounting bracket slots, then slide the end through the retaining clip. Push the clip close to the bracket.

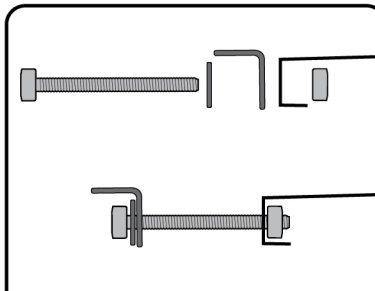

**4** Assemble the tightening mechanism in the above manner.

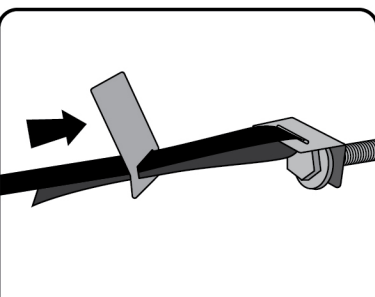

**5** Insert the loose strap into tightening mechanism slot, then slide through retaining clip, making sure to push the clip close to the mechanism.

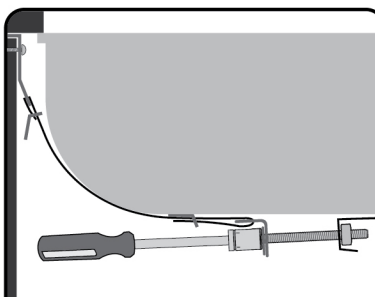

**6** Tighten the adjustment bolt, being careful not to lift the countertop.

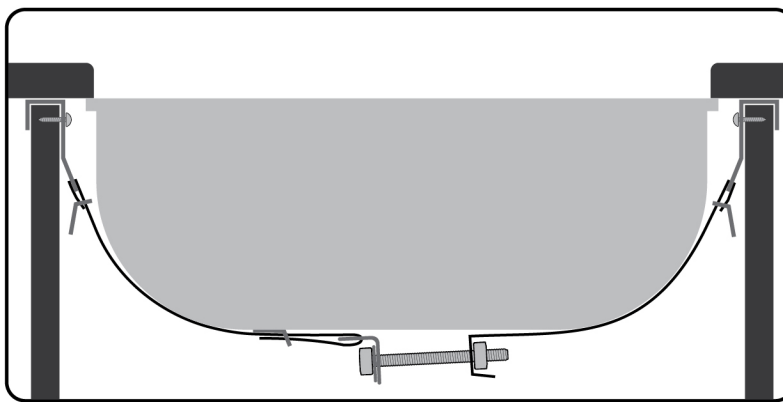

## Sinkits Sink Strap with LC Bracket Instructions *(LC Bracket sold separately)*

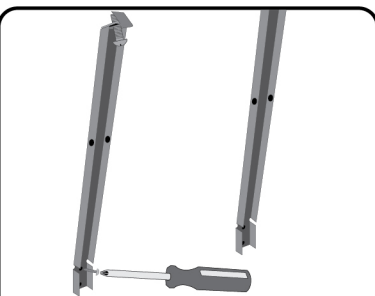

**1** Install LC Brackets (sold separately)

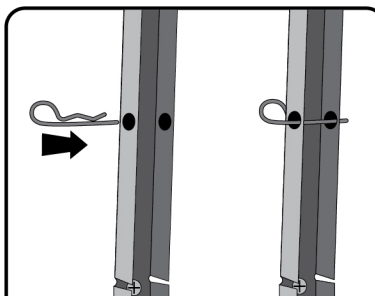

**2** Insert hitch pin clips as shown into the premade LC Bracket holes.

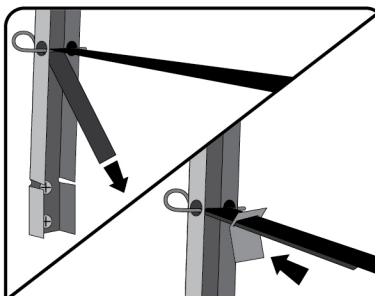

**3** Mount the prebent strap ends over the hitch pin clips, then slide the end through the retaining clip. Push the clip close to the bracket.

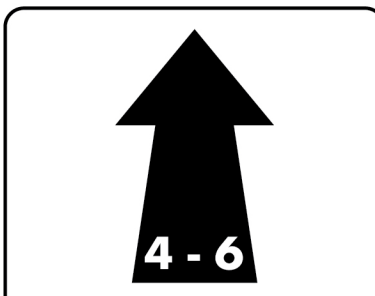

**4** Follow steps 4 - 6 above to finish installation.

Disclaimer and limitation of liabilities: Sinkits Sink Straps are designed for the purpose of attaching undermount sinks to solid surfaces such as stone, quartz or products of similar characteristics. The end user must determine the number of Sink Straps required to properly complete the task and that the material the Sink Strap screws are being inserted into has the characteristics needed to support the product being attached. Persons installing Sinkits Sink Straps must be familiar with the process of undermounting sinks beneath counter tops and that person assumes the responsibility of insuring the Sink Straps are properly secured. All responsibility as to the appropriate use of this product is the responsibility of the user. This product is intended to be used by professional personnel who are competent to evaluate the limitations and proper placement and application of its intended use and that person should accept the responsibility that the product is adequately installed.