

CounterBalance®



SKU: CCH-CBFFIA
AVAILABLE COLOR:



FLOAT FRAME

Island Arm Bracket

Specifications and Installation

- Low-profile brackets provide a clean, “floating” look for your kitchen countertop
- Mounts on half walls to create extended ove hangs on islands, peninsulas, & bar tops
- Heavy-duty construction with load limits of 750lb per bracket
- Available in 10”, 16” & 22” lengths
- Innovative design mounts to vertical studs for high strength and easy installation without routing or cutting
- Proudly made in the USA



MODEL #	BRACKET LENGTH	MAXIMUM COUNTER	DIMENSION A	DIMENSION B	WEIGHT CAPACITY
CCH-CBFFIA12	10”	12”	13.5”	3”	750#
CCH-CBFFIA18	16”	18”	19.5”	6”	750#
CCH-CBFFIA24	22”	24”	25.5”	9”	750#

Weight capacity is based on evenly distributed static loads.

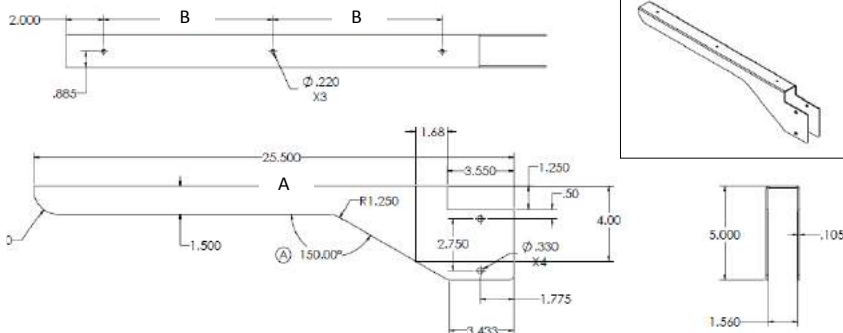

Chemical Concepts™

Call To Order (800) 220-1966

410 Pike Road • Huntingdon Valley, PA 19006

www.chemical-concepts.com

CounterBalance®



SKU: CCH-CBFFIA
AVAILABLE COLOR:



FLOAT FRAME Island Arm Bracket

Specifications and Installation

Installation:

- Select the bracket size(s) required for your installation from the chart below. We recommend a maximum bracket spacing of 32" on center based on standard counter top materials.
- Mount each Float Frame Island bracket using a lag bolt in the top hole. Adjust and level Float Frames to be in plane and permanently fasten the Float Frames to the studs using lag bolts through the remaining holes in the side flanges.

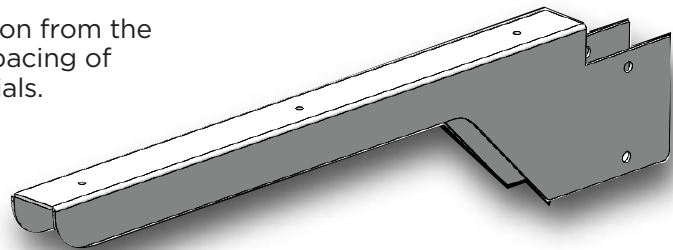

Chemical Concepts™

Call To Order (800) 220-1966

410 Pike Road • Huntingdon Valley, PA 19006

www.chemical-concepts.com