

Application: metal and not metal sheets.  
Assembly: with special hand or pneumatic tools.

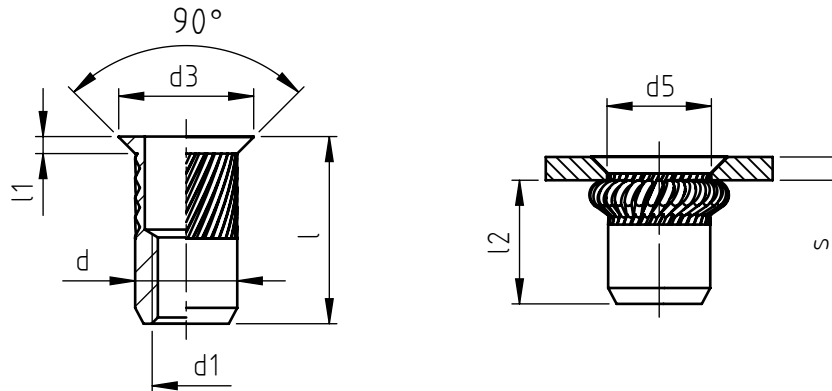

code	steel	stainless steel	s grip	l	d1 6H	d	d3	l1	d5 +0,15 0	l2 *
9202A/M 3/ __Z__	8ZI	XZI	1,6 ÷ 3,5	10	M 3	5	8	1,5	5	5,5
9202B/M 3/ __Z__	8ZI	XZI	3,5 ÷ 5,0	11,5						
9202A/M 4/ __Z__	8ZI	XZI	1,6 ÷ 3,5	11	M 4	6	9	1,5	6	6
9202B/M 4/ __Z__	8ZI	XZI	3,5 ÷ 5,5	13						
9202A/M 5/ __Z__	8ZI	XZI	1,6 ÷ 4,0	13	M 5	7	10	1,5	7	7,5
9202B/M 5/ __Z__	8ZI	XZI	4,0 ÷ 6,0	15						
9202A/M 6/ __Z__	8ZI	XZI	1,6 ÷ 4,5	16,5	M 6	9	12	1,5	9	11
9202B/M 6/ __Z__	8ZI	XZI	4,5 ÷ 7,0	19						
9202A/M 8/ __Z__	8ZI	XZI	1,6 ÷ 5,0	17,5	M 8	11	14	1,5	11	11
9202B/M 8/ __Z__	8ZI	XZI	5,0 ÷ 7,5	20						
9202A/M10/ __Z__	8ZI	XZI	1,6 ÷ 5,0	21	M10	13	16	1,5	13	14
9202B/M10/ __Z__	8ZI	XZI	5,0 ÷ 7,5	23,5						
9202A/M12/ __Z__	8ZI	XZI	1,6 ÷ 5,0	24,5	M12	15	18	1,5	15	17,5
9202B/M12/ __Z__	8ZI	XZI	5,0 ÷ 8,0	27,5						

Non binding dimensions, expressed in mm.

\* Dimension determined from the average of the grip "s" min and max values.

For type B, the knurling might start under the head.

Standard     
  On demand     
  Not manufactured

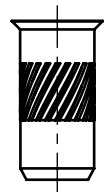

Ref. UNI 9202 standard

Material: steel nr.1.0718  
stainless steel nr.1.4305

Finishing: steel: white zinc-plated  
stainless steel: natural

Tolerances: according to UNI standards EN 22768-1

Thread: ISO 6 H metric

Example: blind threaded nut, countersunk head,  
round knurled inclined shank, stainless steel,  
grip 2,0 mm, M 6 thread:

9202A/M 6/XZI

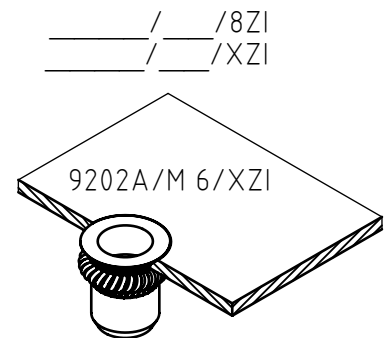

Headquarter and Export department:  
Via Montalcone 144 - 10136 - Turin - IT - Tel. +39.011.700301 - Fax +39.011.702947

Milan branch:  
Via E. Cialdini 37 - 20161 - Milan - IT - Tel. +39.02.646.8476 - Fax +39.02.662.00275

Production and purchase departments:  
Via E. Pavanello 1 - 30030 - Maerne di Martellago (Venice) - IT - Tel. +39.041.503.0100  
Fax +39.041.503.0110